



The SHORTSTOP® 300 SphericaB-WAY™ Tee, 4" and larger, is furnished with a flange, drilled, faced and pressure-rated to match ASME Class 300 flanges. They are used with TDW plugging machines to temporarily plug the line, without shutdown, while installing a

Dimensions



Dimensions and Part Numbers

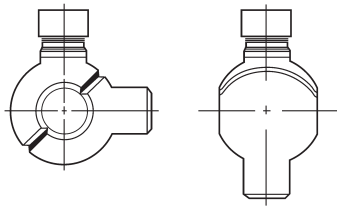

Dimensions

Size

A

B

C



T.D. Williamson

2100.008 S