

T.D. Williamson

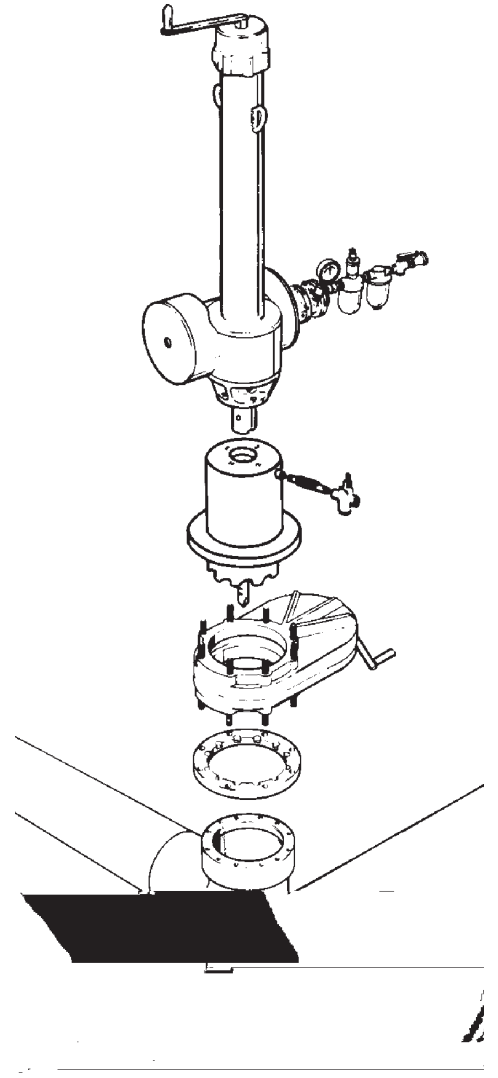

## Dimensions and Part Numbers

Size			Approx. Weight		Design Factor**				Nominal Wall Thickness
Inches	DN	Part Number	Lb.	Kg.	0.72	0.60	0.50	0.40	Side Outlet
1-1/4	32	06-7313-0000	4	1.8	285	285	285	285	Schedule 40
1-1/4	32	06-8619-0000	4	1.8	285	285	285	285	Schedule 40
1-1/2	38	26-0219-0000	6	2.8	285	285	285	285	Schedule 40
2	50	26-0220-0000	7.5	3.5	285	285	285	285	Schedule 40
3	80	26-0221-0000	13	6	285	285	285	285	Schedule 40

\* For thin wall pipe to side outlet.

\*\* Maximum Allowable Operating Pressure (in psi), Per ASME B31.8 at -20 to +100° F

NOTE: Drilling and plug setting at pressures to 285 psi at 100° F using high pressure, full-opening (2-1/16 in. and 3-1/16 in.) tapping valve or new SHORTCUTT® 500 Valves.

Size			Weight		Design Factor**				Nominal Wall Thickness
Inches	DN	Part Number	Lb.	Kg.	0.72	0.60	0.50	0.40	Side Outlet
4	100	06-7239-0400-01	35	16	285	285	285	285	Schedule 40
4	100	06-7239-0400-02	35	16	285	285	285	285	Schedule 40
6	150	06-7239-0400-03	61	28	285	285	285	285	Schedule 40

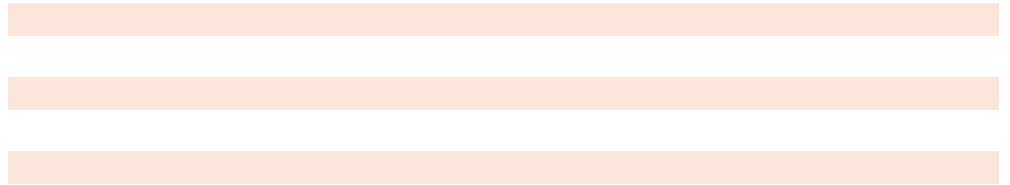

## Spare Parts

Inches	Size		Spare O-Rings Part Number	Type IIa* Spare Gaskets Part Number
	DN			
1-1/4	32		00-0117-0014	--
1-1/2	38		00-0117-0010	--
2	50		00-0117-0010	--
3	80		00-0117-0013	--
4	100		00-1250-0001	00-5238-0004-01
6	150		00-1250-0002	00-5238-0006-01
8	200		00-1250-0003	00-5238-0008-01
10	250		00-1250-0004	00-5238-0010-01
12	300		00-1250-0005	00-5238-0012-01

\*For use with Type IIa flanges only. Consult factory if gaskets are needed for Type II flanges.

